

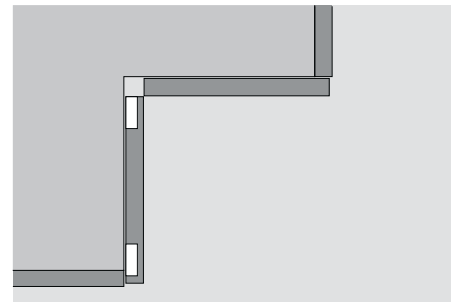

Features

- 60° opening angle
- Spiral tech side adjustment for door gap
- Spiral tech depth adjustment for in/out
- Four-dimensional adjustment
- All metal hinge, nickel-plated



CLIP top/CLIP

Inside corner application

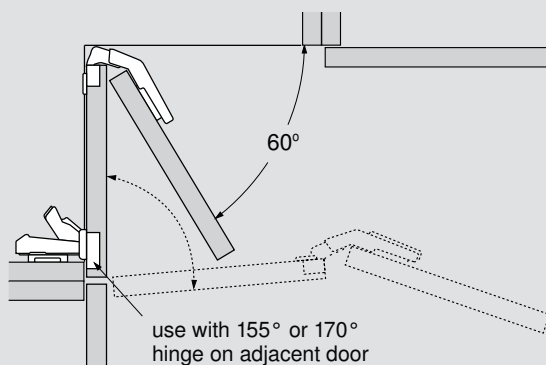

Calculating door sizes

The doors for a CLIP top bi-fold application can be of equal or unequal width. To calculate the door width (DW) of each door follow the step-by-step below.

- Step 1.** Add the interior width to the side panel width (W)
- Step 2.** Subtract door thickness (T) and reveal (R)
- Step 3.** Subtract gap (G) and bumper thickness behind adjacent door

Formula: $DW = (IW + W) \text{ minus } T \text{ minus } R \text{ minus } G$

Example: $DW = (500 + 19) - 19 - 3 - 1$
 $DW = 496 \text{ mm}$

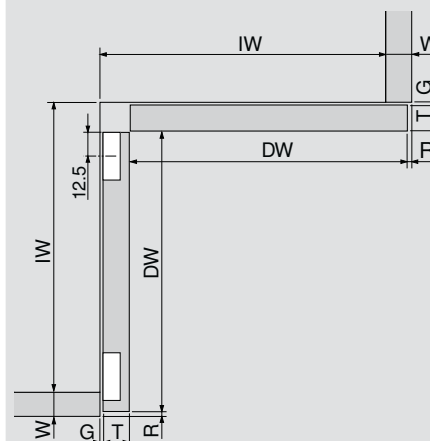

With flat panel doors

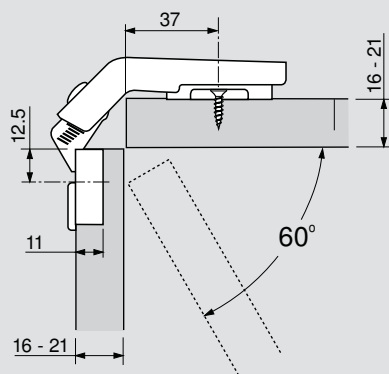

With profile doors

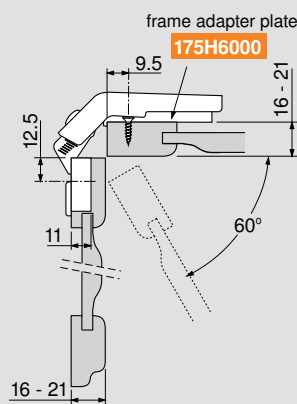

Adjustment

The Spiral Tech cam adjustment of the CLIP top bi-fold hinge allows +4/-7 mm adjustment.

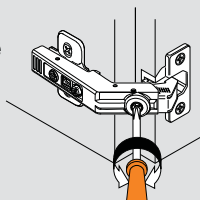

General specifications

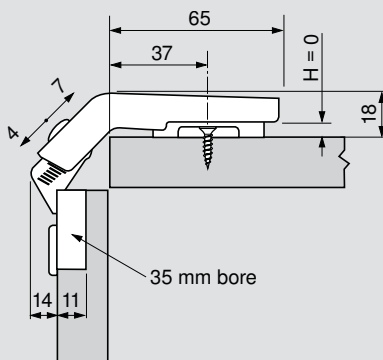

Bi-fold hinges	Self close
Screw-on	79T8500.10
Press-in	79T8530.10

Abbreviations

DW	= Door width
G	= Gap
H	= Plate height
IW	= Interior width
R	= Reveal
T	= Door thickness
W	= Side panel width